

# Product parameters

## 9 series infusion pump



VP-M9

Hardware configuration	4.2-inch HD screen	Automatic pump door
Mode	RVT, Dose, Weight, Relay, Gradient, Drip, First Delivery, Drug, Loading Dose, Micro, Sequence, Intermittent, TCL, PCA, TPN, Blood Transfusion, Oncology Therapy;	
Volume	0.01~9999.99mL, step by 0.01mL	
Rate	0.01-2000mL/h, step by 0.01mL/h	
Sound	≤40dB	
Accuracy	±4%    ±3%	Dynamic pressure sensitive detection (dedicated consumables)
DERS	DERS intelligent medication system	
Information Transmission	Support WIFI, HL7, Wired	
Dimensions	216×122×72mm(width×depth×height)	1.3kg

## 9 series syringe pump



SP-M9

Hardware configuration	4.2-inch HD screen	Manual and Auto-integrated push handle
Mode	RVT, Dose, Weight, Relay, Gradient, First Delivery, Drug, Loading Dose, Micro, Sequence, Intermittent, TPN, Blood Transfusion, Oncology Therapy;	
Volume	0.01~9999.99mL, step by 0.01mL	
Rate	0.01-2000mL/h, step by 0.01mL/h	
Sound	≤40dB	
Accuracy	±1.5%	High sensitive detection of occlusion pressure(dedicated extension tube)
On-site detection	Yes	
DERS	DERS intelligent medication system	
Information Transmission	Support WIFI, HL7, Wired	
Dimensions	275 x125 × 72mm(width×depth×height)	1.5kg



PCA unit



Handle



Data interconnection

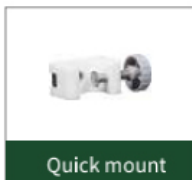

Quick mount



Adapter

## MEDCONCEPT TECHNOLOGY LIMITED

ADD.: B301, LANGUANG TECHNOLOGY PARK, NO. 27, GAOXIN NORTH SIXTH ROAD, NANSHAN DISTRICT, 518057, SHENZHEN, P.R. CHINA  
 TEL/FAX: +86-755-23732826 WHATSAPP: +8618682316345  
 EMAIL: INFO@MEDCONCEPT-TECH.COM  
 WEBSITE: WWW.MEDCONCEPT-TECH.COM

MEDCONCEPT



Infusion workstation  
 Central infusion monitoring system

# Smart Infusion, Lead Future

## Upgrade Large Touch Screen, Easy to Operate Clearly and Lvely

- High-definition screen: 4.2inch IPS HD touch screen, viewing support 170° for all data showing
- Sensitive operation: Millisecond level response without any delay for operation even with gloves
- Automatic pump door: open the door with one button in place to reduce the misoperation of door open
- Manual and Auto-integrated push handle: intelligent sense of syringe push handle position, automatically eliminate sensor clearance, fast start infusion



## Medical Advice Linked with Drug Library, Double Assurance Infusion Safety

- Medical advice issue: Easy to connect with HIS, automatic issue the medical advice to the pumps to realize the close system

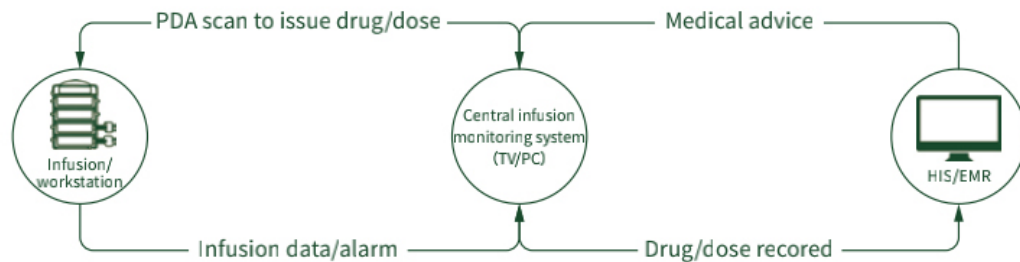

- Drug library support: Equipped with drug color recognition system, built-in drug library and DERS, instant warning of specification and dosage errors



Drug selection			
Propofol	10mg/mL	100mg	50mL
Fentanyl	0.02mg/mL	1mg	50mL
ADRENALINE	1mg/mL	50mg	50mL
Sufentanil	0.4mg/mL	20mg	50mL

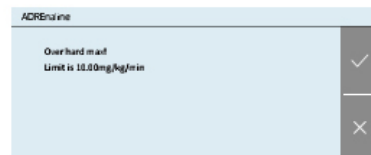

## System Interconnected, Information Integrated

- Remote monitoring: Use the central monitor system or mobile terminal to collect the infusion data, achieve the remote monitoring out of the ward
- Nursing record: Automatically record and load the infusion time, dose volume, infused volume to the system, save the time on paper working
- Data sharing: Support HL7 protocol, infusion log data is open to share, collect the data in time, and rejection of information islands

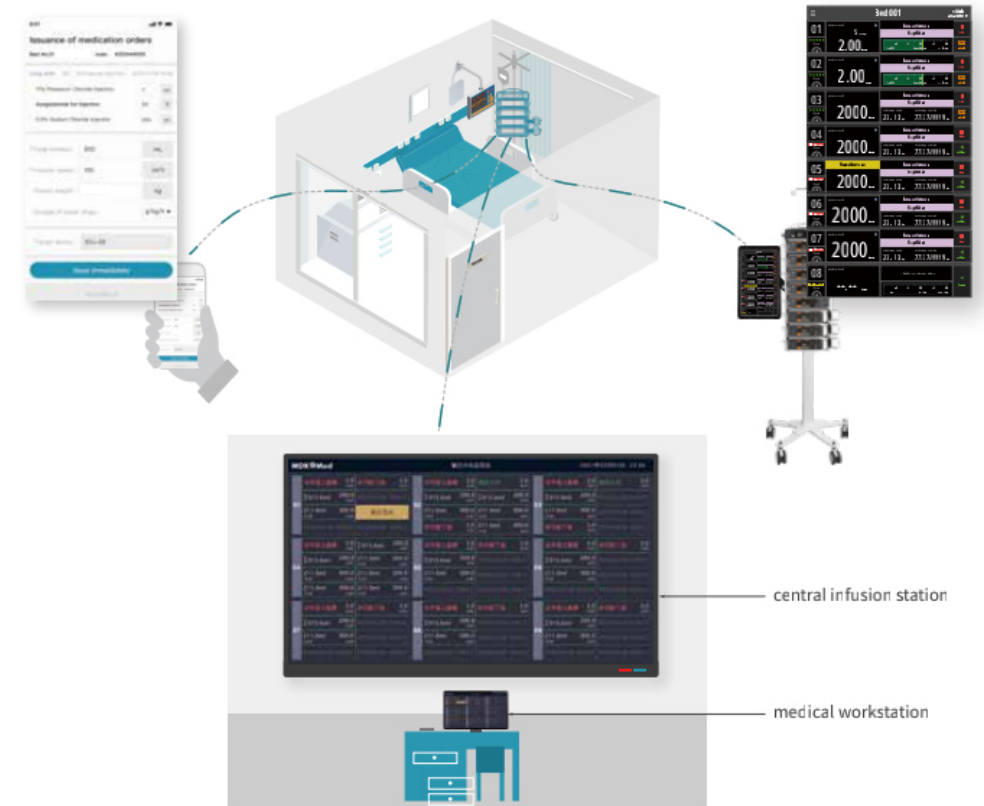

## Flexible Docking, Easy to Stack

- Flexible docking: Free combination to 2-24 channels, match various infusion scenes easily
- Easy insertion and removal: the sequence of single pump can be adjusted freely, which is more convenient for clinical application
- Safety warming: Support constant heating during the infusion

2 channels(general ward)

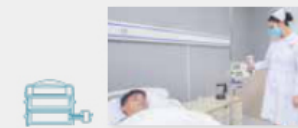

4-8 channels(ICU)



10-24 channels(ICU)

